

HUDSON RIVER

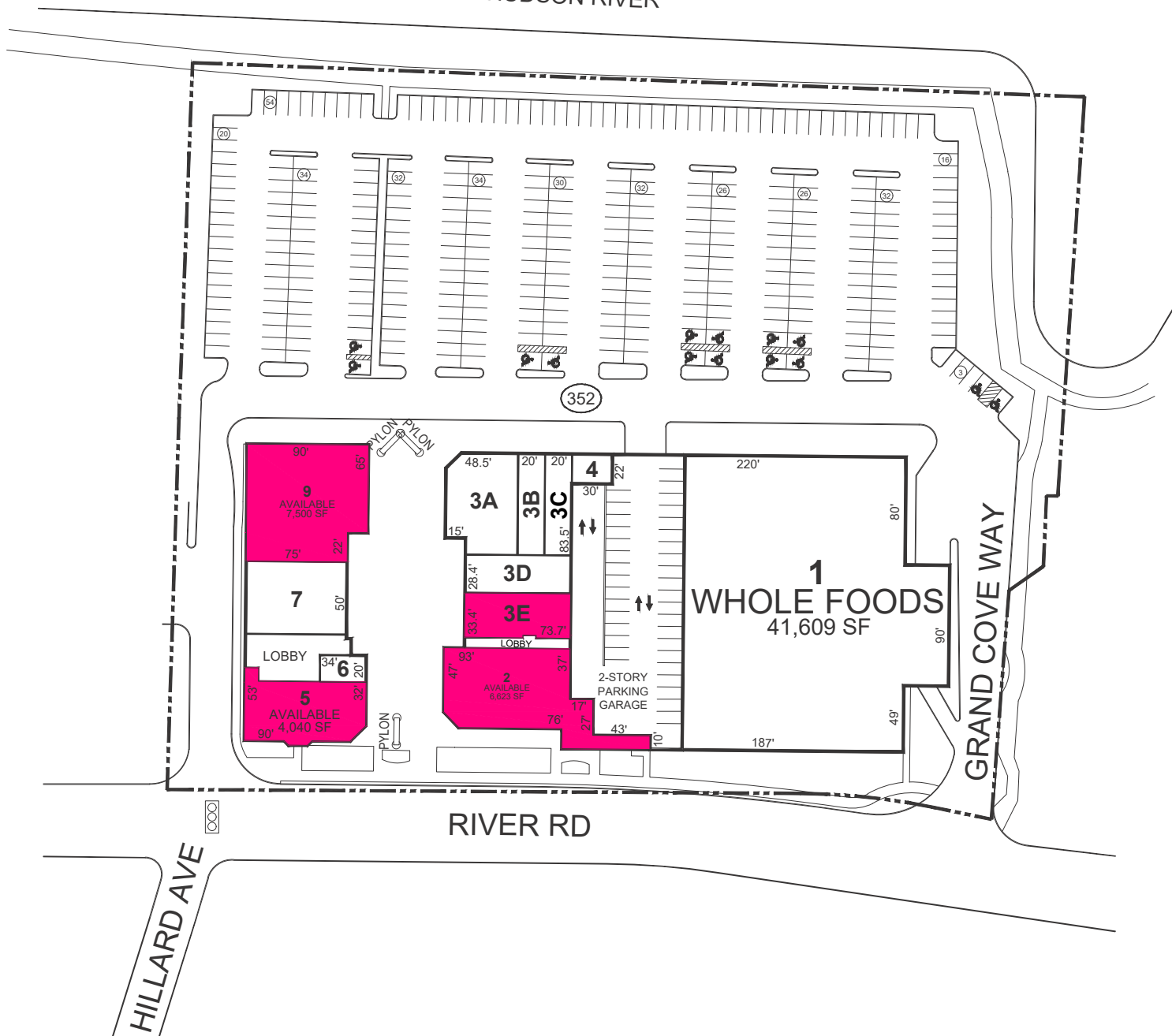

TENANT INDEX

1	WHOLE FOODS	41,609
2	AVAILABLE	6,623
3A	TREK BICYCLE	3,500
3B	AMAZING LASH STUDIO	1,488
3C	PURE BARRE	1,670
3D	CLUB PILATES	2,100
3E	AVAILABLE	2,422
4	ECO FRIENDLY CLEANERS	662
5	AVAILABLE	4,040
6	BRIDGESIDE DENTAL	688
7	BLU SALON	4,050
9	AVAILABLE	7,500

RIVER RD

HILLARD AVE

GRAND COVE WAY



EDGEWATER TOWNE CENTER

905 River Rd
EDGEWATER, NJ 07020

Latitude: 40.8249, Longitude: -73.9733



AVAILABLE

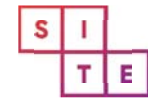

THIS DRAWING IS FOR GENERAL INFORMATION PURPOSES ONLY AND IS INTENDED FOR USE AS A REFERENCE ONLY. THIS DRAWING IS NOT INTENDED TO REPRESENT THE ACTUAL SIZE, DIMENSIONS, OWNERSHIP, OR TENANCY OF THE MATTERS DEPICTED. ANY AND ALL FEATURES AND INFORMATION ARE FOR ILLUSTRATIVE PURPOSES ONLY, AND ARE SUBJECT TO CHANGE WITHOUT NOTICE.

3300 Enterprise Parkway, Beachwood, OH 44122
Fax 216 . 755 . 1500 Phone 216 . 755 . 5500

HUDSON RIVER

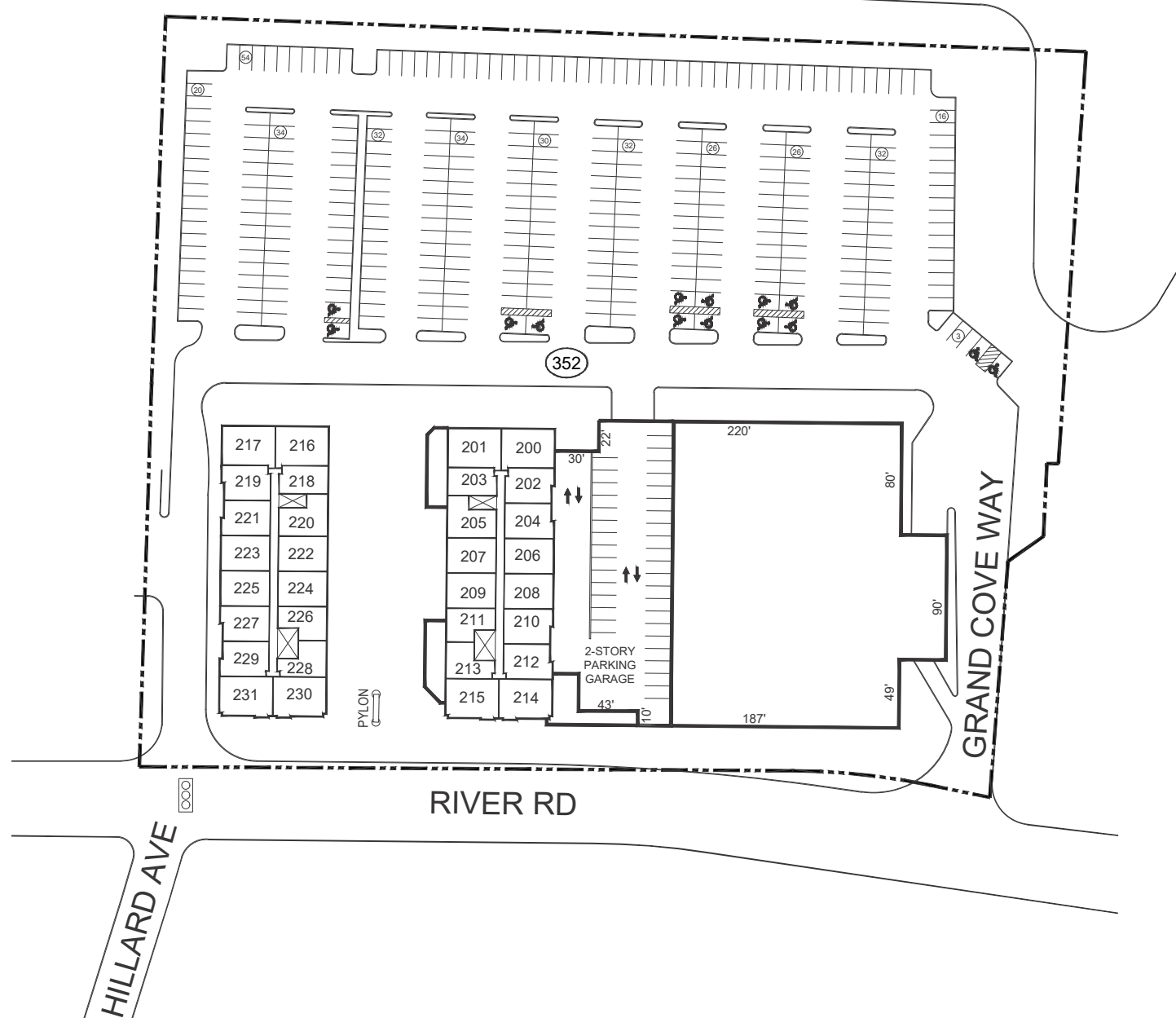

RESIDENTIAL

EDGEWATER TOWNE CENTER - LEVEL 2

905 River Rd
EDGEWATER, NJ 07020

Latitude: 40.8249, Longitude: -73.9733



THIS DRAWING IS FOR GENERAL INFORMATION PURPOSES ONLY AND IS INTENDED FOR USE AS A REFERENCE ONLY. THIS DRAWING IS NOT INTENDED TO REPRESENT THE ACTUAL SIZE, DIMENSIONS, OWNERSHIP, OR TENANCY OF THE MATTERS DEPICTED. ANY AND ALL FEATURES AND INFORMATION ARE FOR ILLUSTRATIVE PURPOSES ONLY, AND ARE SUBJECT TO CHANGE WITHOUT NOTICE.

3300 Enterprise Parkway, Beachwood, OH 44122
Fax 216 . 755 . 1500 Phone 216 . 755 . 5500

HUDSON RIVER

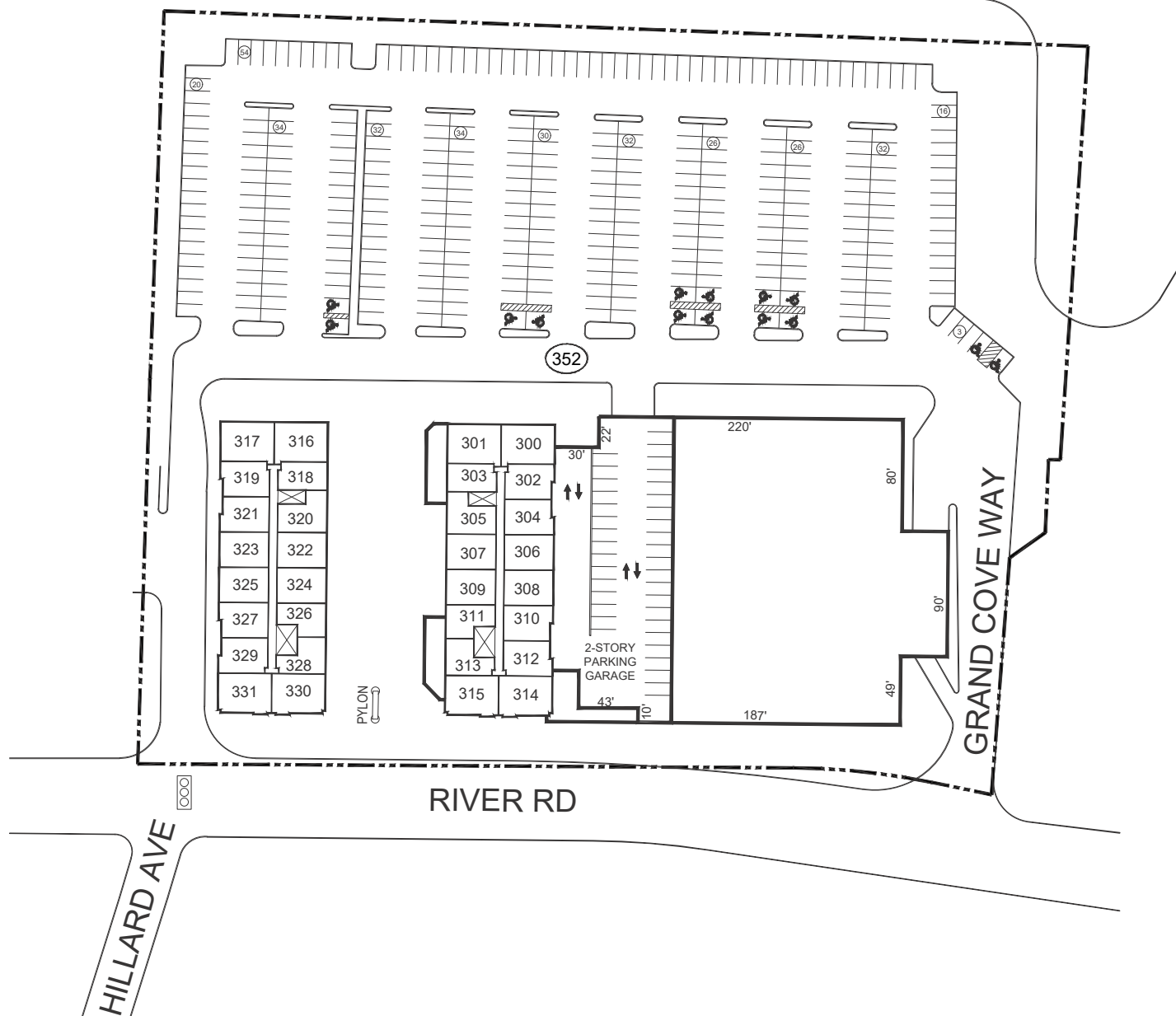

HILLARD AVE

RIVER RD

GRAND COVE WAY

RESIDENTIAL

EDGEWATER TOWNE CENTER - LEVEL 3

905 River Rd
EDGEWATER, NJ 07020

Latitude: 40.8249, Longitude: -73.9733



THIS DRAWING IS FOR GENERAL INFORMATION PURPOSES ONLY AND IS INTENDED FOR USE AS A REFERENCE ONLY. THIS DRAWING IS NOT INTENDED TO REPRESENT THE ACTUAL SIZE, DIMENSIONS, OWNERSHIP, OR TENANCY OF THE MATTERS DEPICTED. ANY AND ALL FEATURES AND INFORMATION ARE FOR ILLUSTRATIVE PURPOSES ONLY, AND ARE SUBJECT TO CHANGE WITHOUT NOTICE.

3300 Enterprise Parkway, Beachwood, OH 44122
Fax 216 . 755 . 1500 Phone 216 . 755 . 5500